

*Medallion*<sup>®</sup>

C A B I N E T R Y

an *ELKAY* COMPANY

# *A Homeowner's Guide to New Cabinetry*



---

*Installation • Final Adjustments • Care and Cleaning*

---

# L I M I T E D   W A R R A N T Y

## Limited Warranty

Medallion cabinets are certified by the Kitchen Cabinet Manufacturers Association (KCMA). This assures you that Medallion cabinets comply with the rigorous standards set by the American National Standards Institute (ANSI).

**Medallion Cabinetry, Inc. warrants its *Designer Gold* and *Designer* cabinetry to be free of defects in material and/or workmanship under normal residential usage to the original purchaser of the cabinetry for as long as they own their home. Medallion warrants its *Silverline* cabinetry to be free of defects in material and/or workmanship under normal residential usage to the original purchaser of the cabinetry for up to ten years or as long as they own their home, whichever is sooner.**

These warranties are only applicable to product used in residential applications within the United States and are not transferable to subsequent owners.

Our obligation under these warranties shall be limited to the repair or replacement of any part or parts that prove defective as determined by our review. These warranties do not cover the cost of installation, removal, subsequent damage, or transportation of the defective product, regardless of who performs the work.

These warranties shall become void if Medallion's products are misused, abused, mishandled, improperly stored, changed, modified, or subjected to extreme temperatures or extreme moisture levels, acts of God or the effects of normal wear and tear. These warranties do not apply to cabinetry ordered and purchased unfinished.

Natural woods vary in color and exhibit color changes as they age. Cabinet colors darken or lighten over time due to sunlight, smoke, household cleaners and other environmental conditions. Painted face frames and other painted product may eventually have visible cracking around the joint areas. These variations are considered the natural characteristics of the material in relation to their environment and are not covered under these warranties. Medallion reserves the right to substitute discontinued product with the most similar styling, wood species, and color available at the time your claim is submitted.

These warranties are the exclusive warranties of Medallion Cabinetry, Inc. and are in lieu of all other warranties, expressed or implied, including the implied warranties of merchantability and fitness for a particular purpose.

These warranties give you specific legal rights. You may have other rights which vary from state to state.

To obtain performance under these limited warranties, first contact your authorized Medallion Cabinetry dealer, who will arrange for an inspection. A dated sales receipt as proof of purchase is required to obtain benefits from these warranties. If a dealer is unavailable, please write to: Warranty Department, Medallion Cabinetry, Inc. at the address listed below, with an explanation of the defect..

These warranties are effective on product manufactured on or after January 3, 2000. Medallion's normal operating procedures and policies apply to the administration of these warranties.

180 Industrial Blvd. • Waconia, MN 55387

To protect your warranty, please read all instructions carefully before beginning installation. Improper installation may cause malfunction of doors, faulty drawer alignment and operation. Final cabinet adjustment requirements are included in this step by step guide.

These instructions, while accurate, may not address the many variations and exceptions encountered while installing cabinetry. To that end, we offer these instructions as a guide to proper cabinet installation. If you encounter variations in your kitchen, please consult a licensed professional.

**You will need:**

- Chalkline
- Countersink
- Electric drill with various bits
- 4' level
- 10' or 12' wood extension rule or tape measure
- Carpenter's square 24" x 16"
- Step ladder
- Screwdrivers
- Screws for countertop (length depends on countertop and shim thickness)
- Pan head sheet metal screws:
  - #8 x 2 1/2" for mounting wall and base cabinets
  - #10 x 3" with flatwashers for mounting ceiling hung cabinets
  - #8 x 2 1/2" for joining face frames
- Wood shims
- Two 4" C-clamps or carpenter style clamps
- Two 1x2x36" wood strips for countertop support with each base Lazy Susan
- 2x4 wall cleat or 2x4 T-brace for installing wall cabinets

NOTE: Please inspect ALL of the cabinetry for damages and color variation before you begin to tear out your existing kitchen. Report all issues at one time to your dealer and not as you install the product. Multiple replacement requests will further delay your project. Once received by Medallion, replacement products will be ready to ship in 7 business days and will ship via cycle truck to your dealer. **Remember, installation of the product indicates acceptance and will not be eligible for replacement or credit.**

# Installation Instructions

---

## Step 1. Prepare the Walls

Cabinets must be mounted level and square. Remove protruding objects from the walls. With a level, check walls for high spots and remove them if possible; otherwise shim cabinets after installation. Use the level to find the highest point of the floor and mark this point along the walls.



## Step 2. Measure and Mark Walls

From the mark on the wall that indicates the high point of the floor, measure  $34\frac{1}{2}$ " up the wall; using a level, draw a horizontal line. This is the top height of the base cabinets. Draw another horizontal line for the top of the wall cabinets (84", 90" or 96" respectively for 30", 36" or 42" high wall cabinets).



## Step 3. Locate Wall Studs

Cabinets must be attached to wall studs for support. Find the studs by using a stud finder, by tapping the wall with a hammer or by driving a nail through the wall board at a height that will later be covered by cabinets. Studs are usually 16 inches apart. Draw a line on the wall at the center location of each stud.

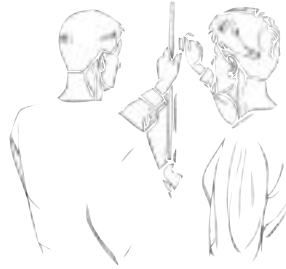

#### 4. Installing Wall Cabinets

For ease of installation, remove doors from the cabinets by unscrewing the hinge from the cabinet front frame. Set the doors aside, stacking them front to front to avoid damage. Remove shelves. Install the corner wall cabinet first. Use a T-brace or nail a 2x4 cleat to the wall at the proper height to support the cabinets during installation. With the cabinet top placed at the line you marked on the wall, transfer the location of the wall studs to the inside of the cabinet. Then, at the wall stud marks, use a 3/32" twist drill bit to drill pilot holes through the hanger rails in the back of the cabinet at top and bottom. Drill these holes into the wall studs also, to a depth of about 1-3/4". Use a 3/16" twist drill bit to enlarge the holes in the hanger rails only. Fasten the cabinet to the wall using two #8x2-1/2" pan head sheet metal screws at top and bottom hanger rails. Do not tighten screws completely until cabinet has been shimmed as needed.

#### DO NOT USE NAILS TO INSTALL CABINETS TO WALL.

Be sure to use a level to check against the front, sides and bottom of each cabinet during installation (see details in Step 9).

NOTE: Tightening hanger rails against a crooked wall without shims can cause the joint between the hanger rail and the cabinet to break. In time, the cabinet could fall off the wall.

**NOTE: ALWAYS INSTALL WALL CORNER CABINETS FIRST!**

#### Step 5. Installing Blind Corner Wall Cabinets

Blind corner wall cabinets can be installed up to 3" away from adjoining wall, providing adequate clearance for cabinet doors. Hang blind corner cabinets as described in Step 4, but a UNF3 filler is required. Attach the filler to both cabinets using the procedure for joining face frames outlined in Step 7.

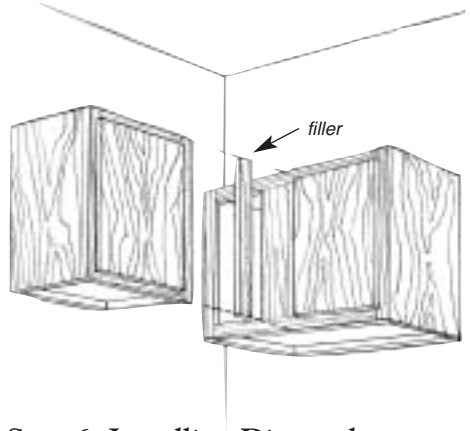

#### Step 6. Installing Diagonal Corner Wall Cabinets

These cabinets require 24 inches on each of two adjoining walls. When installing, use your level to be sure cabinets are level vertically and horizontally before securing to wall. Proper installation of other cabinets will depend on level installation of the corner cabinet.

### Step 7. Joining Face Frames

Make sure cabinet face frames are flush at top and bottom. Hold cabinets together with C-clamps at top and bottom while installing. Use a 1 1/32" twist drill bit to drill a hole part way through one cabinet stile (the vertical portion of the face frame) at top and bottom. At the center of these holes, use a 1/8" twist drill bit to drill a pilot hole the rest of the way through the cabinet stile, about 1" into the adjoining cabinet stile. Fasten cabinets together with #8x2-1/2" pan head sheet metal screws. If necessary, shim between wall and cabinet, then tighten screws completely, making sure screws go into studs at least 1".

NOTE: Shorter screws may be required for fillers that are to be trimmed.

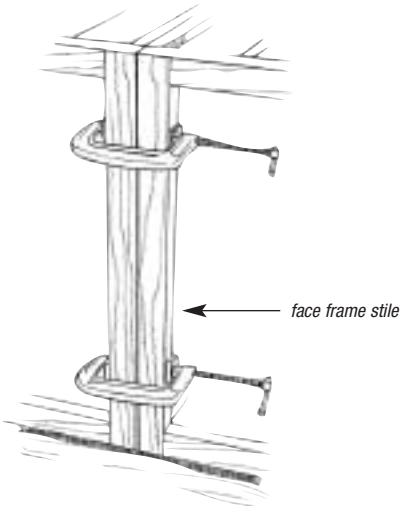

### Step 8. Installing Ceiling Hung Cabinets

Locate ceiling joists above wall cabinets. Using a 3/32" twist drill bit, drill four pilot holes through the top frame of the cabinet, about 1-1/2" into the ceiling joist. Use a 3/16" twist drill bit to drill through the top frame of cabinet only at the pilot holes. Fasten cabinets to ceiling using #10x3" sheet metal screws. Use flat washers with each screw to better distribute load to prevent screw heads from pulling through. Join face frames using procedure in Step 7.

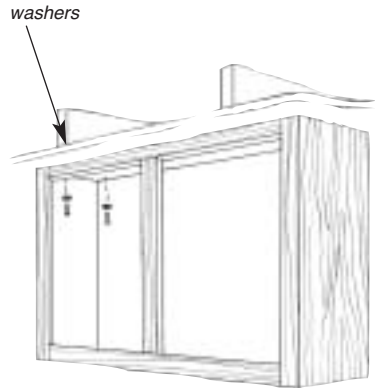

## Step 9. Leveling Cabinets

After hanging each wall cabinet, check with a level against front, sides and bottom of cabinet to ensure it is plumb and level. If necessary, shim between wall and cabinets to correct for uneven walls. You may need to loosen screws slightly to insert shims. Shim ceiling-hung cabinets as necessary between ceiling and cabinet. After alignment, tighten all screws securely.

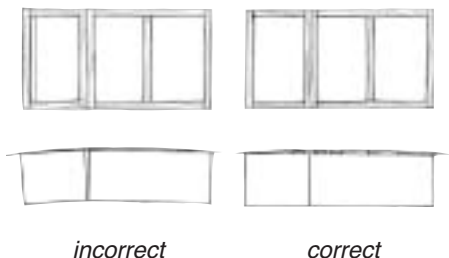

## Step 10. Installing Base Cabinets

Install base cabinets after ceiling or wall-hung cabinets. For ease of installation, remove doors from the cabinets by unscrewing the hinge from the cabinet front frame. Remove the drawers. Set the doors aside, stacking them front to front to avoid damage. Remove shelves. Start from one corner. Using a 1/8" twist drill bit, drill holes through the top rail at back of cabinet at stud location marked on wall, about 1-1/2" into the stud. Secure cabinet to the wall using #8x2-1/2" sheet metal screws, making sure screws go into studs at least 1". Use a level to check against front, sides and top of cabinet (see Step 14). Shim between wall and cabinet and between floor and cabinet as necessary to keep cabinet plumb and level and aligned with base cabinet mark on wall from Step 2.

NOTE: Tightening hanger rails against a crooked wall without shims can break joint between hanger rail and cabinet.

## Step 11. Installing Base Cabinets with Blind Corner

NOTE: ALWAYS START IN THE CORNER! Since each unit differs, check layout drawing to determine proper distance from adjoining wall. Position and secure cabinets using same procedure as for base cabinets (Step 10), except that a BF3 filler is required. Attach base filler to both base cabinets using procedure for joining face frames (Step 7).

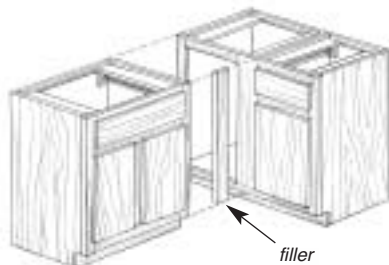

## Step 12. Installing Lazy Susan Base Cabinet

Square and level installation assures smooth operation, as well as proper installation of remaining cabinets. Provide support for the countertop in the corner behind the Lazy Susan by securing two 36" lengths of 1x2 stock to the wall; level these two pieces with the base cabinet mark from Step 2.

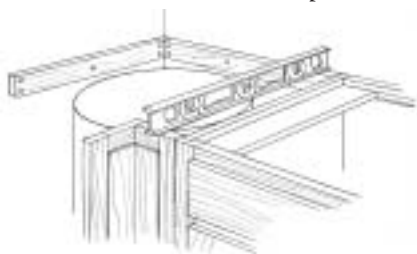

## Step 13. Fastening Base Cabinets Together

Fasten adjoining cabinets together using the procedure for joining face frames (Step 7).

## Step 14. Leveling Cabinets

Check each cabinet as it is attached to wall, front to back and across front edge with a level. Be certain cabinet is level in both directions. Shim between cabinet and floor or between cabinet and wall to keep base units level and plumb. Shim between back rail and wall as necessary to prevent rail from bowing when secured to wall. Tighten all screws.

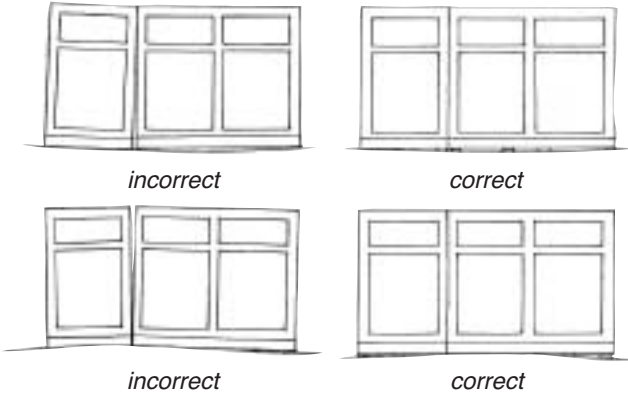

## Step 15. Installing Countertop

Follow countertop manufacturer's instructions for proper installation. Base cabinet I-beams should be utilized when attaching countertop. Be careful to use the proper length screw and not to over-tighten, damaging the countertop. Screws should be placed no further than 1" from the front or back of the cabinet.

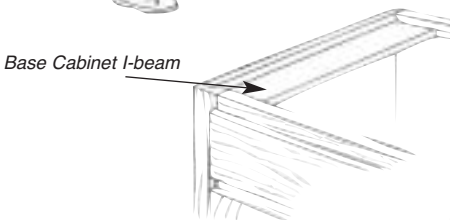

## Step 16. Adjusting Cabinet Doors

Replace doors and drawers removed during installation and adjust as needed. Loosen vertical adjustment screw on each hinge. Align cabinet door to frame, then re-tighten screws. Loosen horizontal adjustment screws, reducing gap between doors by moving left or right, then tighten screws. See hinge illustrations next page.

All cabinets require final adjustments after initial installation.

**Problem:**

Door does not close properly against cabinet face frame at either top or bottom.

**Solution:**

This could be a result of improper adjustment of door hinges, the cabinet is not installed “square,” or door warpage due to insufficient humidity. Loosen mounting screws and shim to make cabinet plumb, level and square. Loosen hinge screws and readjust. If necessary, install humidity control to keep relative humidity to 35%.

**Problem:**

Space between two butt doors exceeds 1/8" or is uneven or doors do not line up properly.



**Solution:**

Your cabinet may not be installed level, or door hinges are not correctly adjusted (see illustrations below). Always use a level on horizontal and vertical surfaces.

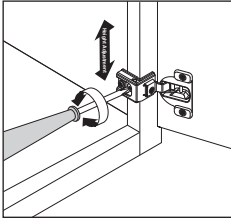

**Height:**

Adjustment of the door up or down, allowing alignment of door tops and bottoms in relation to the frame or as compared to the drawer front.

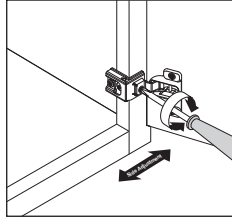

**Side:**

Allows the door to be moved from side to side giving you the ability to adjust the gap on butt doors to accommodate humidity changes in the home.

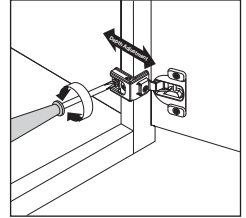

**Depth:**

Allows adjustment of the door closer to, or further away from the face frame. This gives you the ability to compensate for any “racking” of the cabinet box during installation.

**Problem:**

Drawer does not close evenly or drawer movement in/out is stiff.

**Solution:**

Adjust drawer guide member attached from front edge of cabinet to back, by manually realigning the drawer guide within the socket itself at the back of the cabinet (see illustration below). Once realigned, check that drawer guide rollers stay in tracks and operate smoothly.

*Move drawer guide member left or right within socket as needed.*

**Note:**

If your cabinetry has **Mirage Smartrac** or **Mirage Smartrac FX** drawer guide: remove the screw that holds the socket to the cabinet back. Move the socket slightly to the left or right as needed, then replace screw.

**Problem:**

Drawer front does not fit flush with cabinet.

**Solution:**

Cabinet may not be installed level. Loosen mounting screws and shim to make cabinet plumb and level. Adjust drawer guide member attached from front edge of cabinet to back, by manually realigning the drawer guide within the socket itself at the back of the cabinet (see illustration above). Once realigned, check that drawer guide rollers stay in tracks and operate smoothly.

**Problem:**

Drawer front is crooked.

**Solution:**

The drawer front is adjustable. Loosen two screws in back of drawer front, even out the drawer front, then tighten screws.

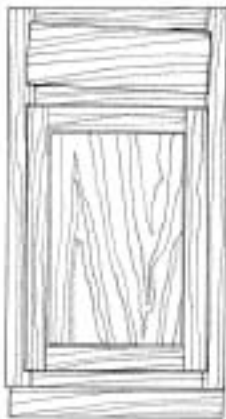
**Step 17. Decorative Hardware**

Install decorative knobs or pulls as desired.

**Congratulations!**

*Your cabinet installation is complete.*

# Cabinet Care & Cleaning

---

## Immediately

As soon as your cabinets are installed, wipe all surfaces with a soft, damp cloth and dry immediately.

Never use kitchen cloths or sponges that might have detergent or grease on them.

## Maintenance of Cabinetry

### Interior and Exterior

- Clean at least once monthly to protect wood and bring out its natural beauty by wiping surface with a clean, damp cloth, then dry.
- To remove soil or grease, use suds from common dishwashing liquid (not detergent). Wipe clean with damp cloth. Dry thoroughly.
- During routine kitchen use, immediately dry cabinets near sink, range, dishwasher, oven and baseboards where water splashes and spills often occur, to prevent damage to your cabinetry finish.
- To protect your cabinets' finish, never use cleaners containing bleach, ammonia or abrasives on your cabinetry.
- *Do NOT wax cabinet surfaces.*
- Never use sandpaper or any other type of abrasive paper or material to “even out” a scratch, as it will damage the cabinet finish.

## Special Care Instructions

### **Breadboard care and cleaning:**

Before initial use, wipe entire board with mineral oil and allow it to soak into the wood. After routine use, wipe clean with a damp cloth and dry thoroughly.

To prevent warpage, cracking, and to ensure long-lasting durability, occasionally sand board lightly with sandpaper and reapply mineral oil. **DO NOT IMMERS**E IN WATER. **DO NOT CLEAN** IN DISHWASHER.

### **White cabinetry next to self-cleaning**

**oven:** When utilizing the “self-cleaning” feature on your self-cleaning oven, open all drawers and doors wide on cabinetry installed next to your oven.

This will prevent possible damage and/or discoloration to your cabinetry that can occur due to high heat build-up next to your oven.

## To repair small scratches, nicks and dents

- Most cabinet scratches can be touched up by using a special kit available from your dealer which includes a touch-up marker, filler pencil and fast-dry touch-up. Start with the touch-up marker.
- If scratches or nicks still show after using a touch-up marker, use a filler pencil. Simply rub the pencil overfilling the scratched area and wipe away excess with a clean soft cloth. Then apply a protective coating of clear Fast-Dry Touch-Up or a clear acrylic spray (available in the paint section of your local hardware store).

## Additional Information

Nature has provided that variations in graining and color may be evident in your wood cabinetry. Since most wood cabinetry is constructed from several pieces, variations occur because each piece accepts stain in a different way.

We feel the beauty of real hardwood is created by these infinite variations of grain, texture and color. This is the nature of hardwood, and unusual graining will not be considered reason for replacement.

Some of our door styles use solid wood raised center panels. Commonly, a small amount of expansion and contraction will occur, depending on the season and humidity.

Our classic white cabinets use a unique thermofoil bonding process for a tough, chip-resistant exterior that's durable and easy to maintain. *Painted* surfaces will develop hairline cracks at joints, caused by seasonal humidity changes and the expansion/contraction of the wood. This is the nature of hardwood, and hairline cracks on painted surfaces will not be considered reason for replacement.

Should you have any further questions regarding the care and maintenance of your cabinetry, please contact your dealer.



***Medallion Cabinetry, Inc.***

an ELKAY COMPANY

180 Industrial Boulevard  
Waconia, Minnesota 55387  
(952) 442-5171  
Fax (952) 442-8316  
1-800-543-4074  
[www.medallioncabinetry.com](http://www.medallioncabinetry.com)